

ATACAMA EVOQUE SPECIAL EDITIONS ASSEMBLY INSTRUCTIONS

BASE MODULE COMPONENTS

SHELF MODULE COMPONENTS



Please note

Bamboo is a natural material so colour, texture, grain and age may vary slightly from shelf to shelf. Because of this, a shelf installed at a later date will introduce a batch and colour difference. Where possible order your rack as a single modular support with enough levels to fulfil your future requirements in order to minimize this variation.

*SE2 foot has 2 locking nuts

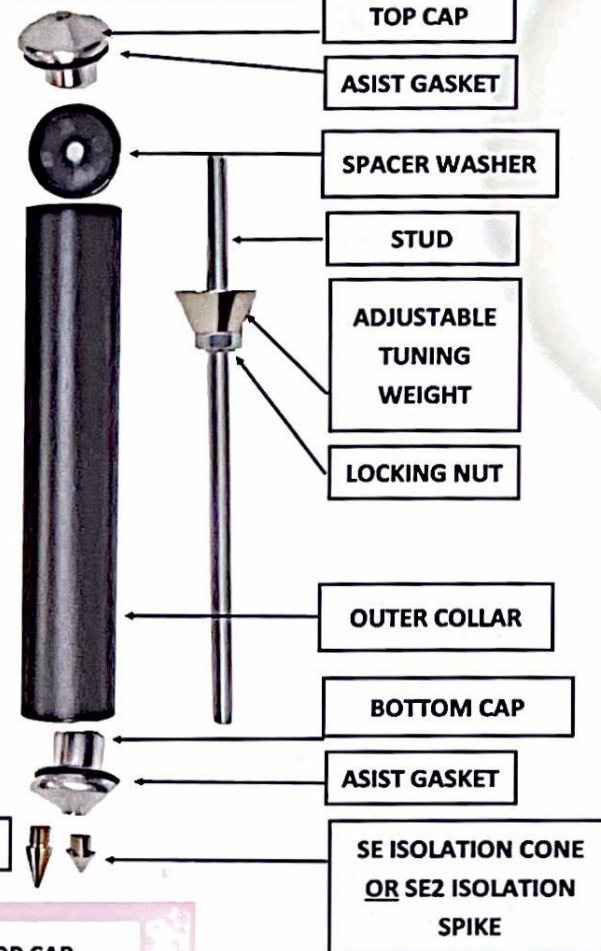
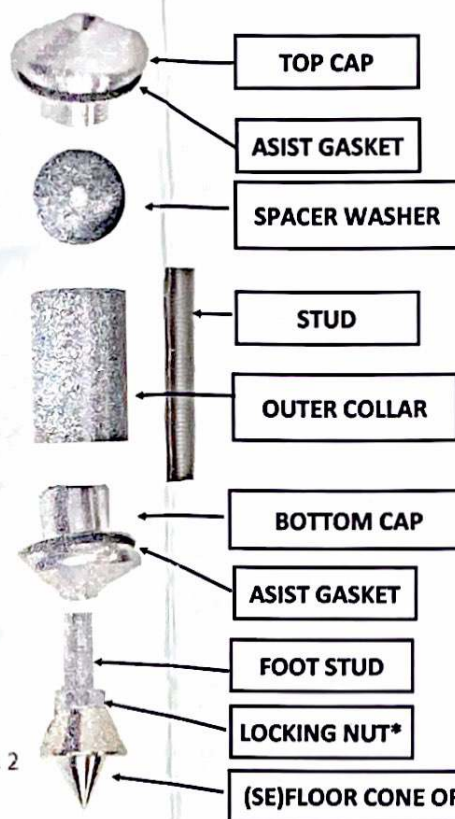

Prepare the studs by positioning the tuning weight.

ADJUSTABLE TUNING WEIGHT
RECOMMENDED POSITIONING CHART

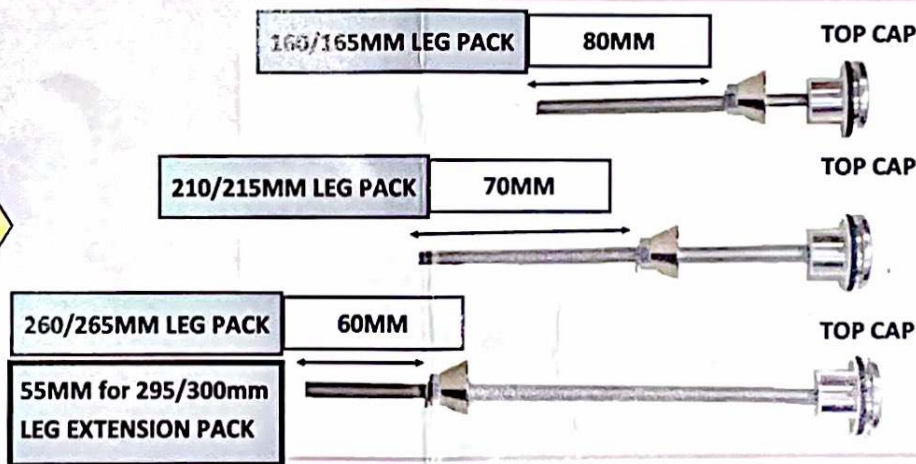

RECOMMENDED DISTANCE FROM THE BOTTOM OF THE STUD TO THE UNDERNEATH OF THE ADJUSTABLE TUNING WEIGHT.
(EXCLUDING LOCKNUT)

ATACAMA EVOQUE SPECIAL EDITION ASSEMBLY INSTRUCTIONS

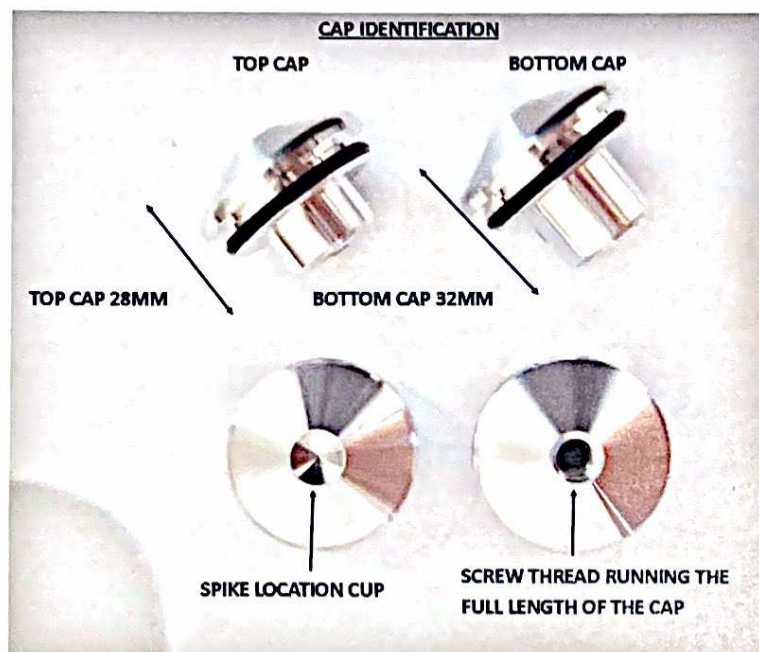

Base Module assembly

THE BASE MODULE IS EXACTLY THE SAME AS THE SHELF MODULE TO ASSEMBLE, HOWEVER THERE IS NO ADJUSTABLE TUNING WEIGHT (this component is incorporated into the base spike assembly), SO IGNORE THAT PART OF THE INSTRUCTIONS.

If the foot stud/ locking nut/ floor cone component requires assembly, follow these instructions:-

Place the locking nut approximately half way up the foot stud

Screw the foot cone tip into the counterweight with the widest face of the counterweight facing away from shelf, then screw onto bottom of the foot stud. The final foot cone assembly should look like this.

SE spike
Base module
spike

SE 2 spike
base module
spike

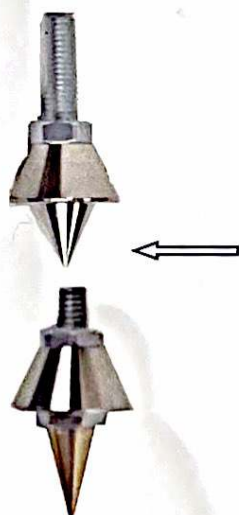

Shelf Module assembly



Place the spacer washer onto the stud as shown, insert stud through the underside of the panel, then tighten the top cap onto the stud.

Position the outer collar over the stud then offer up the bottom cap to the lower end of the stud. As you tighten the bottom cap the spacer washer will self locate into the panel.



Slide the outer collar over the completed stud assembly and screw on the bottom cap.

Place the isolation cone into the bottom cap. (If it is a base module, fit the foot assembly as described opposite.)

The final leg assembly should look like this.

(The SE2 version will have the upgrade cone)

